

# Escape



**Kent** Fire &  
Rescue Service

together

**Task 1:** Select a character and cut it out carefully.  
You can even choose a pet or another family  
member to join you.



**Kent** Fire &  
Rescue Service

**together**

**Task 2:** Colour and cut out your flame ready to use in your escape plan.



**Kent** Fire &  
Rescue Service

together

**Task 3:** Now you're ready to have a practise on paper. Use Elsa and Woody's house to help you first.

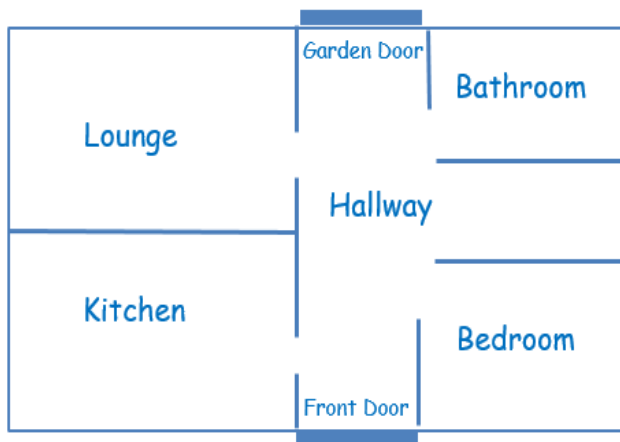

Place your character and the flame on the plan. How you would get out safely?

**Challenge:**

What happens to your escape plan if you change where the fire is?



**Kent** Fire &  
Rescue Service

**together**

**Task 4:** You will need a pencil. Draw a layout of your home.



**Kent** Fire &  
Rescue Service

**together**

**Task 5:** Place your character and the flame on your drawing of your home.

1 How would you escape? What would you need to think about?

2 What would happen if you changed where the fire had started?

3 How would that change your escape plan?

4 Are the exits locked? Does everyone know where the keys are or how to unlock the door?

5 Are the hallways clear?

6 Have you got a meeting point? (If not, you can decide on one now)



**Kent** Fire &  
Rescue Service

together

**Challenge:**

If the fire is ....., I would need to

---

---

---

---

---

---

---

Go to [www.thebyrnes.co.uk](http://www.thebyrnes.co.uk) for more helpful tips and activities.



**Kent** Fire &  
Rescue Service

together